

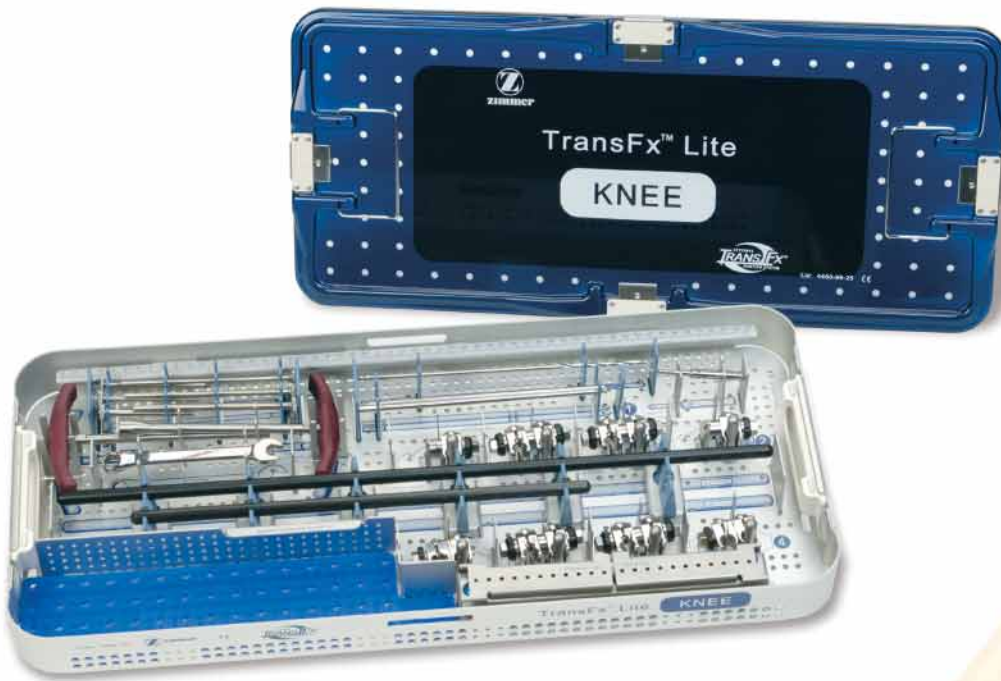

TransFx™ Lite Knee Spanning Frame

Abbreviated
Surgical Technique



Labeled with specific frame construct to bridge the fracture site while soft tissue injuries subside

Intuitive, single layer cases designed to minimize inventory requirements

Time-saving and convenient for managing high energy injuries in the middle of the night

Efficient and easy to use for quick application, adjustment, and reduction



zimmer
Confidence in your hands®

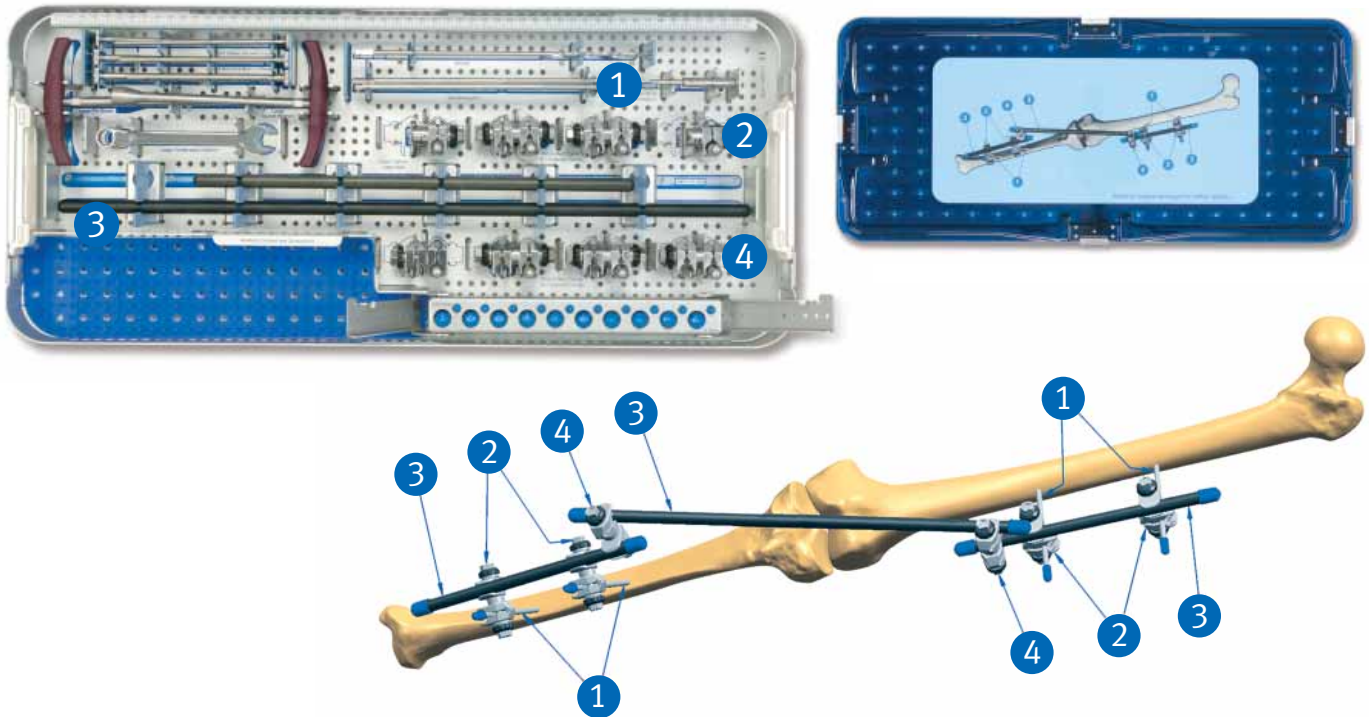

1 Build Femoral Construct

A. Insert two *TransFx* half pins ①* in safe zone of femur independently in an anterior to anterolateral position. Place distal pin first proximal to the fracture site keeping in mind planned future fixation. Insert second pin proximal to first pin at a maximum distance to ensure stability of frame.

Note: Pre-drilling is optional when using the TransFx self-drilling, self-tapping half pins.

B. Loosely finger tighten pin-to-rod clamp ② on each pin.

C. Attach appropriate length carbon fiber rod ③ into rod-to-rod clamps (or universal clamps) connecting the two femoral pins. The construct should be approximately two finger breadths above skin to allow for swelling. Tighten speed nuts on pin-to-rod or universal clamps.

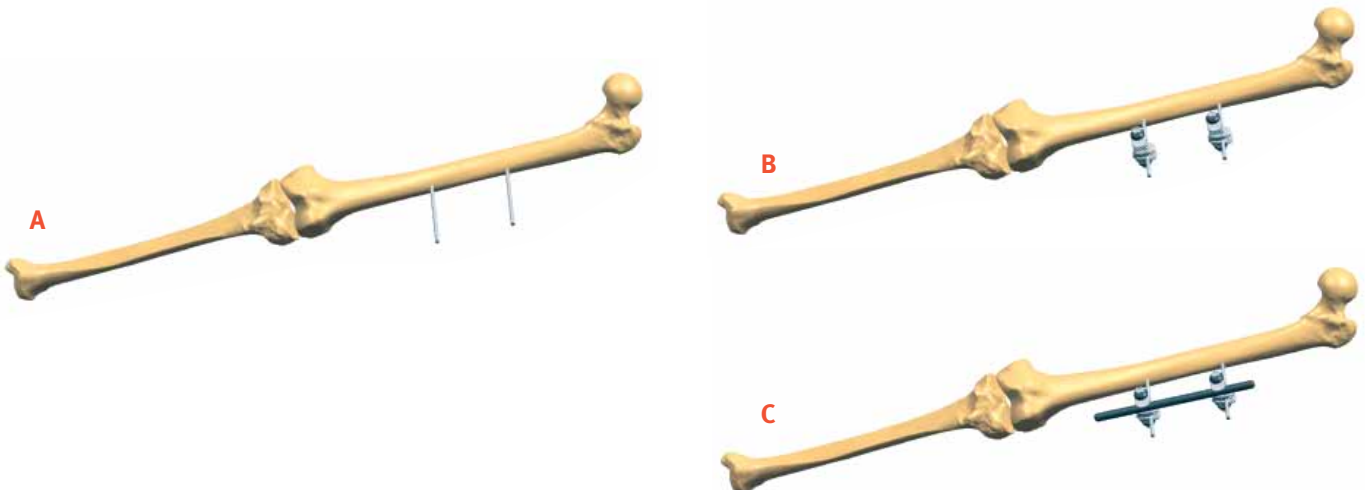

* Numbers in written text refer to numbers on lid underside and inside on the bottom of the case.

2 Build Tibial Construct

Follow steps in Step 1.

Adhere to safe zone for tibial half pin placement in the medial subcutaneous surface and start with proximal pin distal to the fracture site keeping in mind planned future fixation.

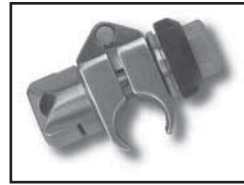
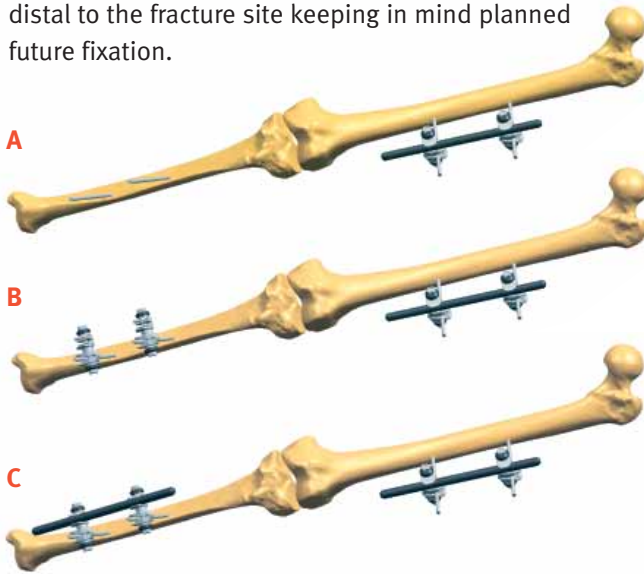

Pin-to-Rod Clamp
00-4452-025-01

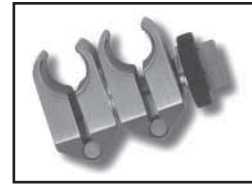

Rod-to-Rod Clamp
00-4452-015-11

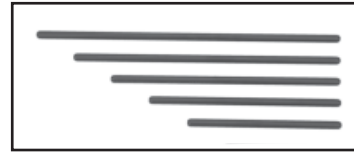

Various Lengths of Rods

3 Attach TransFx Rod-to-Rod Clamps

Attach one rod-to-rod clamp (or universal clamp) ④ on the distal end of femoral carbon fiber rod and one on the proximal end of tibial carbon fiber rod. Only finger tighten speed nuts until final reduction is achieved in Step 4. Place protective cap on end of rods to keep the rod-to-rod (or universal clamp) from slipping off the rod.

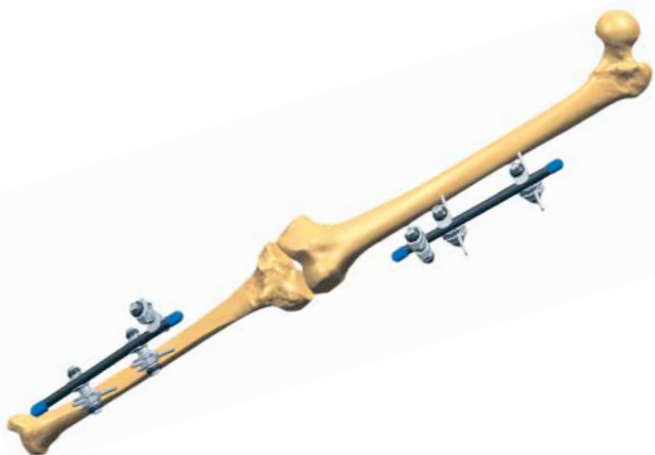

4 Connect Femoral and Tibial Construct

Connect femoral construct to tibial construct with appropriate length carbon fiber rod ③ snapping rod into rod-to-rod (or universal clamps) positioned in Step 3. Distract, align and reduce fracture. Confirm with C-arm and completely tighten all clamps. Place protective caps on pins and rods.

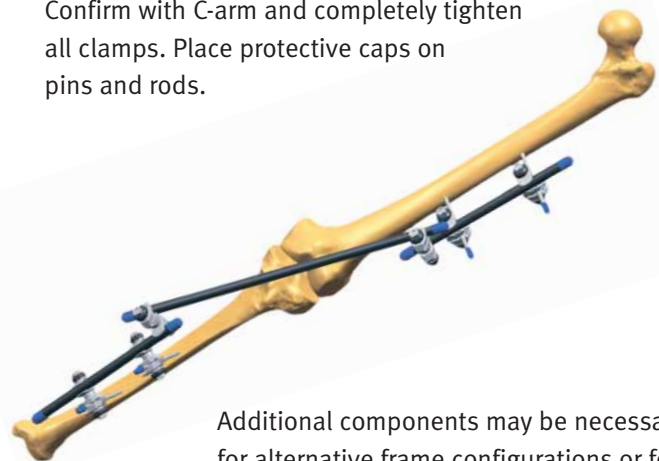

Additional components may be necessary for alternative frame configurations or for added frame stability.

Ordering Information

Prod. No.	Description	QTY
00-4450-025-00	Knee Spanning Case	
00-4450-025-02	Knee Spanning Implant Kit Includes the following:	
00-4451-001-30	Carbon Fiber Rod, 11mm X 300mm	3
00-4452-015-11	Rod to Rod Clamps, 11mm	2
00-4452-025-51	Pin to Rod Clamps, 11mm	4
00-4452-092-11	Protective Caps, 11mm	1 pk of 10
00-4452-092-45	Protective Caps, 4.5/5.0mm	1 pk of 10
00-4454-050-20	Self Drilling Pin, 5.0 X 200mm	4



Universal Clamp

Allows independent loosening and tightening capability on both sides of clamp for ease of frame construction. It is truly universal and can be used in place of the *TransFx* Pin-to-Rod or *TransFx* Rod-to-Rod clamp for simple inventory management. 4.5, 5.0 and 6.0mm pins conveniently snap-fit into the clamp which is useful in hard to reach spaces. The Universal Clamp is only available in the Large 11mm system.



Speed-Nut Technology

Innovative Speed-Nut clamp technology allows for initial finger tightening and therefore, provides ease of use, flexibility, and speed in frame construction.

Prod. No.	Description	QTY
00-4450-025-01	Knee Spanning Instrument Kit Includes the following:	
00-4450-049-00	Drill Sleeve Set w/Trocar, (2 each) 4.0/5.0mm X 135mm	1
00-4450-067-00	Drill Bit, 4.0mm x 230mm QC	1
00-4450-075-00	Combi Wrench, Large	1
00-4450-082-00	Pin Driver, Large	1
00-4450-093-00	Large Quick Connect to Hex Adapter	1
Additional components may be ordered separately.		
00-4452-055-11	Universal Clamp (Optional)	



Quick Connect to Hex Adapters

When speed and efficiency are important for the OR, the Quick Connect to Hex Adapters are a time saving tool that allows pins to be placed by easily sliding in and out of the adapter without the use of a Jacobs Chuck. The large adapter holds 4.5, 5.0 and 6.0mm pins while the intermediate adapter holds 2.5, 3.0, 3.5 and 4.0mm pins.



Pin Driver

Designed to manually insert or remove three (4.5, 5.0 and 6.0mm) pin diameters.

Reference *TransFx* External Fixation System Large and Intermediate Surgical Technique 97-4450-003-00 for further details.

Contact your Zimmer representative
or visit us at www.zimmer.com

